

SoCS Council Meeting

Oct 11, 2016

AGENDA

1. Approval of Agenda
2. Approval of Minutes from Sep 27, 2016
3. Interim Director's Remarks — Pascal
4. T&P Guidelines — Pascal
5. PhD QE and Thesis Defence Regulations — Yang
6. Summer Semester — Dave Calvert
7. Target Enrolment — Michael
8. Director Search — Gary
9. Any other business

AGENDA

1. Approval of Agenda
2. Approval of Minutes from Sep 27, 2016
3. Interim Director's Remarks — Pascal
4. T&P Guidelines — Pascal
5. PhD QE and Thesis Defence Regulations — Yang
6. Summer Semester — Dave Calvert
7. Target Enrolment — Michael
8. Any other business

3. INTERIM DIRECTOR'S REMARKS

3. INTERIM DIRECTOR'S REMARKS : Director Position

External reviewers' recommendations:

- ☐ Appoint an interim director asap for about 1 year
- ☐ Start an internal and external search for a new director who will be willing to serve a full term to start in about 1 year

Options:

- ☐ External Search
- ☐ Internal Search
- ☐ Pascal

3. INTERIM DIRECTOR'S REMARKS: Teaching-Focused Faculty Positions

Members of the Search Committee:

- ☐ Dan Gillis
- ☐ Deb Stacey
- ☐ Michael Wirth

- ☐ ???
- ☐ ???

3. INTERIM DIRECTOR'S REMARKS: Research-Focused Faculty Positions

Members of the Search Committee:

- ☐ ???
 - ☐ ???
 - ☐ ???
- } Nominations by Wed, Oct 19, 4pm

- ☐ ???
- ☐ ???

3. INTERIM DIRECTOR'S REMARKS: Analyst III Position

19 applications
2 candidates short-listed
1 interview tomorrow morning
1 interview Friday morning

3. INTERIM DIRECTOR'S REMARKS: Contractors for Reynolds

5 contractors invited
5 proposals
3 short-listed
3 interviews tomorrow

3. INTERIM DIRECTOR'S REMARKS: Reynolds Floor Plans



3. INTERIM DIRECTOR'S REMARKS: Reynolds Floor Plans



3. INTERIM DIRECTOR'S REMARKS: Reynolds Floor Plans



First Floor (11 offices)

3. INTERIM DIRECTOR'S REMARKS: Reynolds Floor Plans

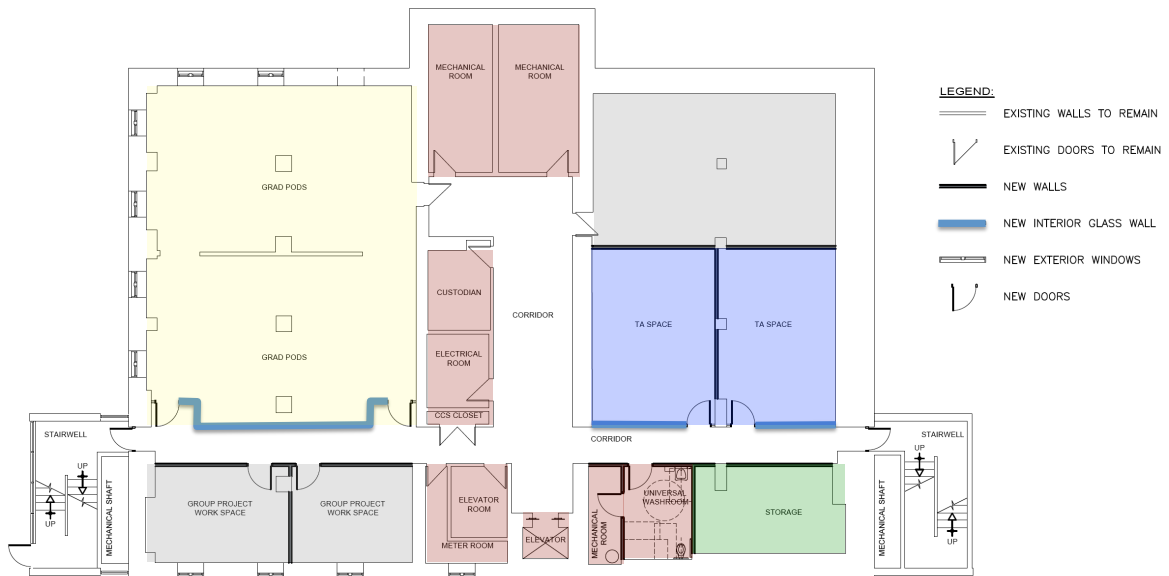

Basement Floor

4. T&P GUIDELINES

4. T&P GUIDELINES

School Guidelines



College Guidelines



addendum

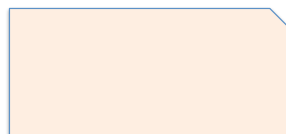

4. T&P GUIDELINES

School Guidelines

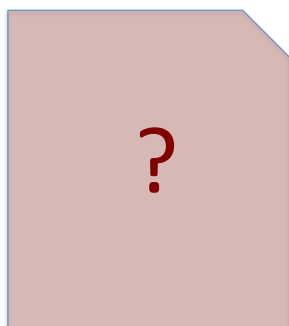

College Guidelines



addendum

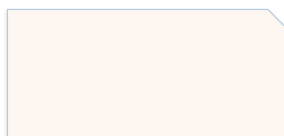

4. T&P GUIDELINES

School Guidelines



College Guidelines



addendum

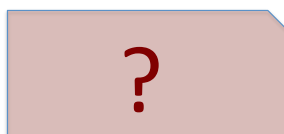

AGENDA

1. Approval of Agenda
2. Approval of Minutes from Sep 27, 2016
3. Interim Director's Remarks — Pascal
4. T&P Guidelines — Pascal
5. Summer Semester — Dave Calvert
6. Target Enrolment — Michael
7. Any other business

5. SUMMER SEMESTER

Curriculum Items
Oct. 11, 2016

Co-op Plans and Things to Consider for This Semester

- New Co-op schedule.
- Delete ISHB
- New 1500 for majors and other computing intensive students.
- Consider moving the simulation and modelling course to third year.
- Reorder semesters 3 and 4.
- Consider if summer semester DE courses should be deleted.
- Move 1910 and 2910 to semesters one and two respectively.
- Consider low enrolment courses and lab lengths.

Benefits of a new Co-op Schedule include:

- Increasing the number of students we can accept into Co-op and overall.
- Creates additional offerings of courses.
- Splits several core courses and potentially reduces class sizes.
- Solves the existing problems with sequencing the CIS*3750 and CIS*3760 courses.

Motion: The School of Computer Science will replace the existing Co-op schedule with one which includes a summer academic semester. This is contingent upon the school receiving funding for the three new tenure track faculty members necessary to support the additional teaching requirements associated with this new schedule.

6. TARGET ENROLMENT

ENROLLMENTS 2009-2016

YEAR	# SOCS Faculty	SOCS (CS/ SE/ ISHB)	% increase from previous	FAC: STU ratio	1500 F	1910 W	2500 W	2030 F	3110 W	
09/10	23	63			543	89	137	59	75	
10/11	22	84	33%		553	121	184	58	70	
11/12	20	89	6%		585	126	203	68	83	
12/13	19	124	39%		655	174	230	81	106	
13/14	18	187	50%		777	237	301	117	153	
14/15	18	240	28%		865	281	370	158	198	
15/16	19	250	4%		864	281	355	195	228	
16/17	20	250	0%		854			197		
19/20	20+					330+	400+			
20/21	20+							240+		
09-15 change					60%	216%	160%	230%	200%	

From 2009 to 2013 there has been a **297%** increase in incoming students.

YEAR	# SOCS Faculty	SOCS (CS/ SE/ ISHB)		FAC: STU ratio	4300 F	3750 F		2500 W	1910 W	2030 F
12/13	19	124			28	31				
15/16	19	250								
16/17	20	250			69	85				
17/18	20+	250			96	117				
18/19	20+	250			110	135				

Enrollment for 16/17 calculated as a percentage of average incoming enrollments for 12/13 and 13/14 = 155. 4300 as a percentage of that is 45%. So estimate for 17/18 is taken from average of 13/14 + 14/15 = 213 * 0.45.